

WinchMaster

SPECIALIST WINCH SOLUTIONS

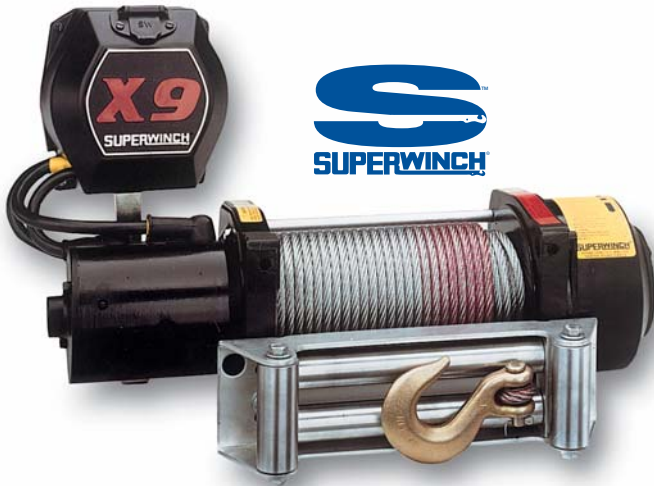

SUPERWINCH X6/X9 12v / 24v Electric Planetary Recovery Winches

FEATURES INCLUDE

- *Power in / power out*
- *Freespooling*
- *Battery cables with terminals*
- *Heavy duty series wound motor*
- *Heavy duty differential planetary gearing*
- *Full load holding drag brake*
- *Remote mountable solenoid station*
- *Prewired with 4.5m handheld remote switch*
- *12 months warranty*
On parts and service (excluding wire rope)
- *Fitting service*
Full or partial fitting can be provided, including load testing and certification
- *After sales service*
Technical advice given on winch fitting and component replacement, plus efficient overnight parts despatch and fast repairs

A SUPERWINCH DISTRIBUTOR WITH THE EMPHASIS ON TECHNICAL EXPERTISE

Professional operators want the best technical advice when selecting a winch. They need to be sure that the product they buy is the safest and most suitable for the job, providing complete reliability and minimal vehicle down time.

Winchmaster sales engineers provide valuable advice and guidance, plus a comprehensive winch installation service. They pride themselves in giving a comprehensive parts backup – with next day delivery throughout the UK.

A service that sets Winchmaster apart from other Superwinch dealers!

APPLICATIONS

4x4 recreational vehicles and light recovery vehicles.

The switching system can also be remote-mounted for a lower more compact winch profile.

OPTIONS

- **FM•CONNECT** remote control

WINCHMASTER Unit 6 South Orbital Trading Park Hedon Road Hull HU9 1NJ

T: +44 (0)1482 223663 F: +44 (0)1482 218285

CALL SALES ON 01482 223663
E: sales@winchmaster.co.uk W: www.winchmaster.co.uk

A DIVISION OF
BHW
GROUP
LIMITED

WINCHMASTER IS A DIVISION OF THE BHW GROUP LIMITED REGISTERED IN ENGLAND No. 1342461

WM04/01.09.07



CERT. No. 1769

PERFORMANCE FIRST LAYER OF CABLE						
LINE PULL kg	LINE SPEED (approx)		Amp Draw (approx)			
	X9	X6	X9		X6	
			12v	24v	12v	24v
0	9.8	5.3	73	35	30	15
454	5.5	4.5	130	62	81	40
907	4.2	3.5	165	88	134	72
1,814	2.7	1.9	240	130	250	125
2,722	1.8	0.8	316	165	400	200
4,082	0.8	-	420	240	-	-

All figures are based on battery maintaining normal voltage.

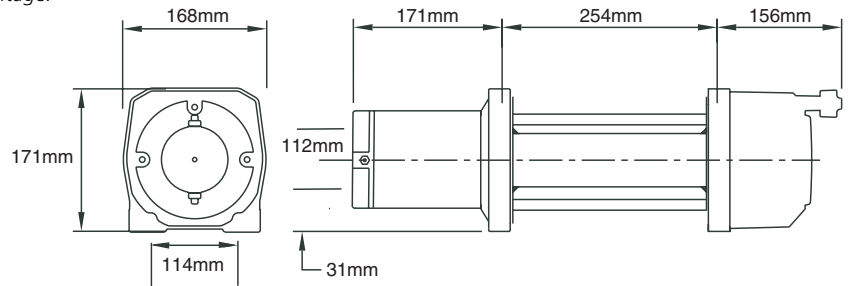

SPECIFICATIONS

	X9	X6
Rated Line Pull (Single Line):	4,082kg	2,722kg
Motor Series Wound:	4.2hp	3.4hp
Gearing:	Differential planetary	Differential planetary
Gear Ratio:	253:1	253:1
Freespooling Clutch:	1/4 turn activation	1/4 turn activation
Braking Action:	Automatic in the drum	Automatic in the drum
Wire Rope:	7.9mm x 30.5m	7.9mm x 30.5m
Dimensions:	581mm x 171mm x 168mm	581mm x 171mm x 168mm
Drum Diameter:	64mm	64mm
Drum Length:	229mm	229mm
Weight:	37kg	33kg

WARNING

These winches must not be used for the movement of personnel and 5 wraps of wire rope must be maintained on the drum.

WARRANTY

Each new winch is guaranteed against defects in workmanship and material defects for a period of twelve months from date of purchase.

WIRE ROPES ARE NOT INCLUDED UNDER WARRANTY.